



**CROWN**  
SURFACE SOLUTIONS

# ZINTRA STICKS

## STICKS TRIM

### INSTALLATION INSTRUCTIONS

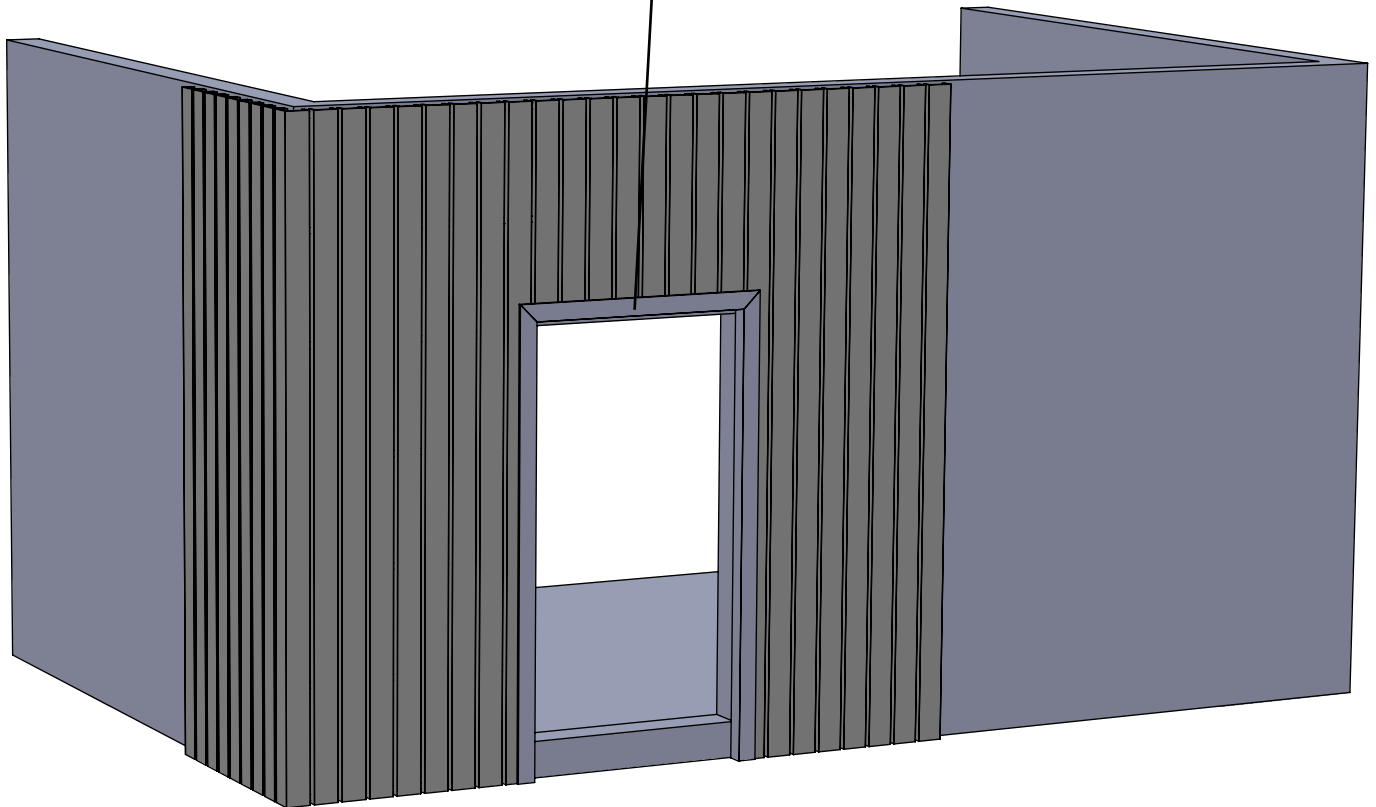
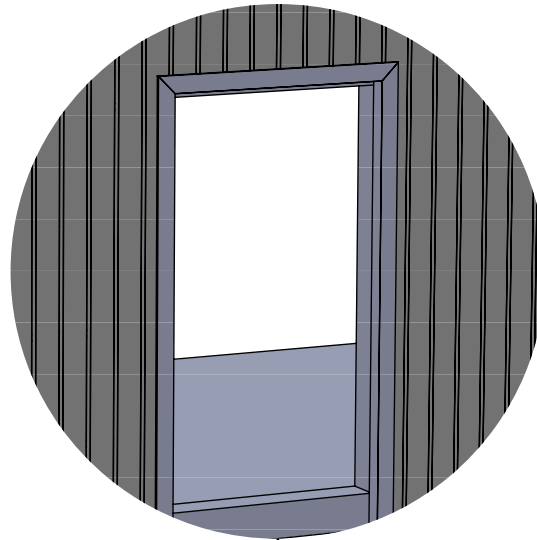

## PARTS AND HARDWARE

ZINTRA STICKS TRIM - *TO BE CUT ON SITE*



UNCUT

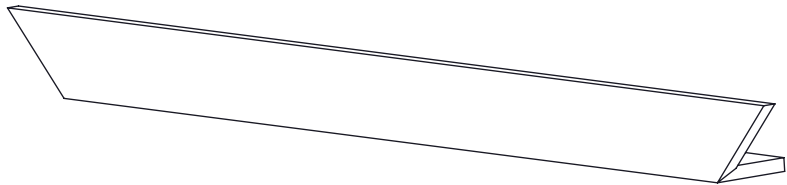

CUT

## YOU WILL NEED

### SUITABLE SCREWS

SCREWS ARE NOT INCLUDED - INSTALLER TO SUPPLY BASED ON FIXING SUBSTRATE



### SPIRIT LEVEL

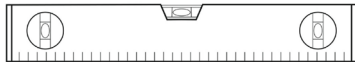

### DROP SAW WITH SUITABLE BLADE FOR ALUMINIUM CUTTING

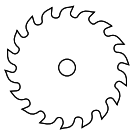

### DRILL

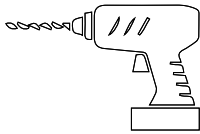

### TAPE MEASURE



### HIGH STRENGTH CONSTRUCTION ADHESIVE



### APPROPRIATE APPLICATOR

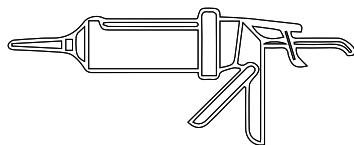

**STEP 1**

MEASURE THE SPACE OF THE DOOR OR WINDOW WHERE THE STICKS WILL BE INSTALLED.

THIS IS GOING TO DETERMINE THE DIMENSIONS AT WHICH THE STICKS WILL BE CUT TO.

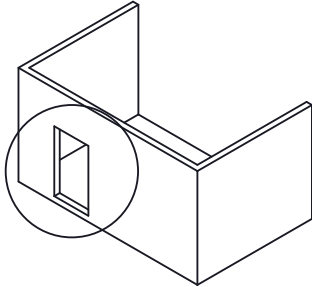

FRONT VIEW

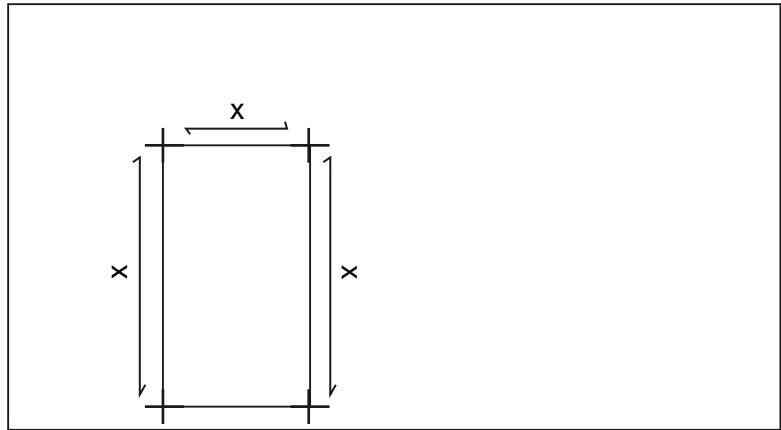

**STEP 2**

MEASURE THE WIDTH [X] OF THE INSTALL AND CUT THE ALUMINIUM TO SUIT

NOTE: AFTER MEASURING AND MARKING WHERE TO CUT THE ALUMINIUM TUBE, COUNT THE NUMBER OF NOTCHES TO ENSURE IT WILL SUIT THE QUANTITY OF STICKS REQUIRED. FOR EXAMPLE, A WIDE STICK USES 4 NOTCHES, THEREFORE THE NOTCHES IN THE ALUMINIUM TUBE WILL NEED TO EQUAL A MULTIPLE OF 4.

USE A LASER LEVEL OR SPIRIT LEVEL TO MARK ALUMINIUM POSITION ON THE WALL

MAX DISTANCE FROM TUBE CENTRES IS 450mm [17.71"]

MAX DISTANCE BETWEEN END OF STICK AND FIRST TUBE CENTRE IS 150mm [5.9"]

INSTALL STANDARD ALUMINIUM TUBE INTO THE WALL. THESE WILL REQUIRE (2) SCREWS PER (1) ALUMINIUM TUBE

NOTE: AN ADDITIONAL ALUMINIUM TUBE NEEDS TO BE INSTALLED ABOVE THE WINDOW/DOOR EDGE. MAX DISTANCE FROM THE EDGE TO NEXT TUBE CENTRE IS 150mm [5.9"]

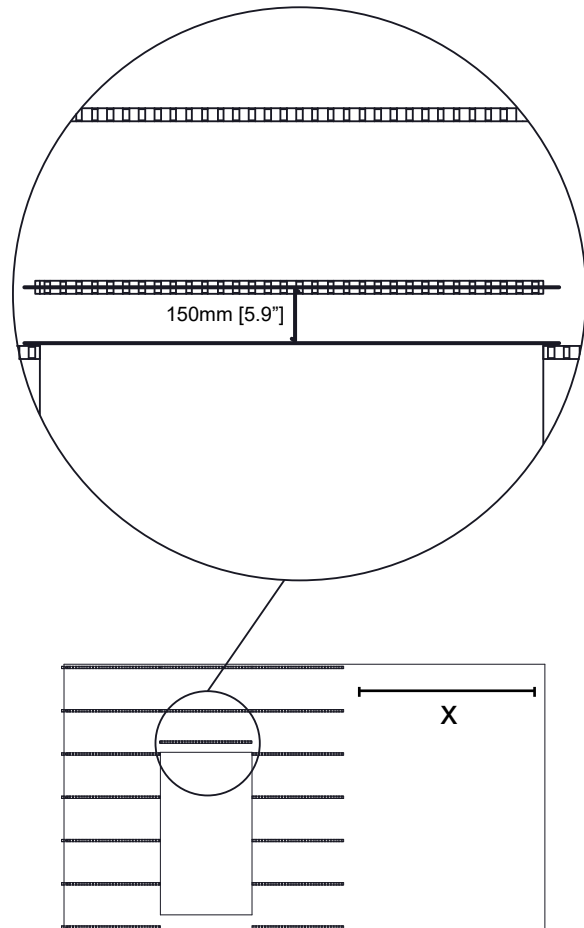

**STEP 3**

DRILL HOLES IN ALUMINIUM TUBES IN LOCATIONS TO SUIT SUPPORT IN WALL (STUD LOCATION ETC)

SCREW ALUMINIUM TUBES TO WALL

DRYWALL SURFACE: USE DRYWALL ANCHOR AND SUITABLE SCREW

TIMBER SURFACE: USE SELF TAPPING TIMBER SCREW

MASONRY SURFACE: USE MASONRY ANCHOR AND SUITABLE SCREW

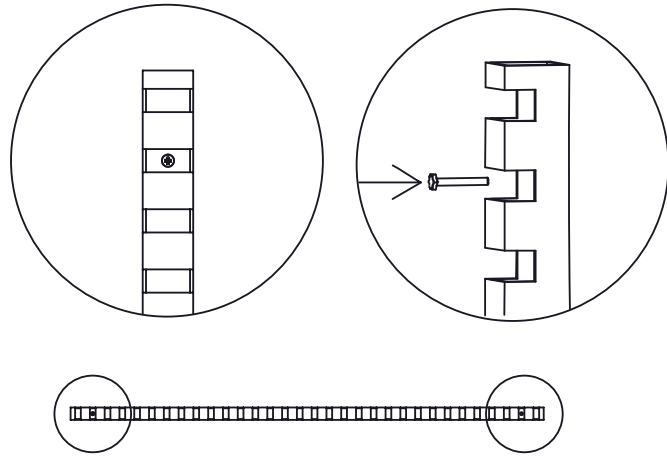

**STEP 4**

FOLD ZINTRA STICKS (8) FOR WIDE OR (16) FOR NARROW PER SET

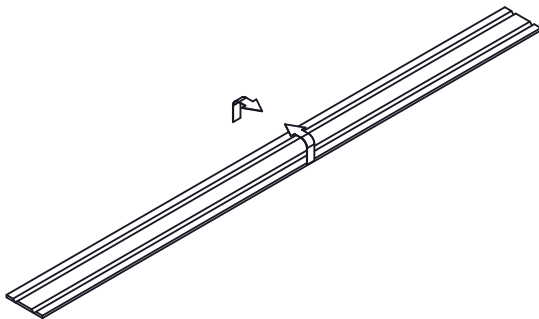
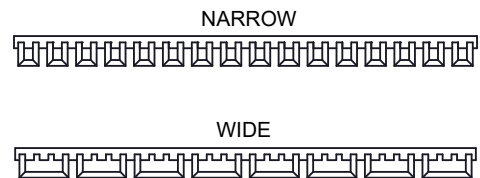

STICK

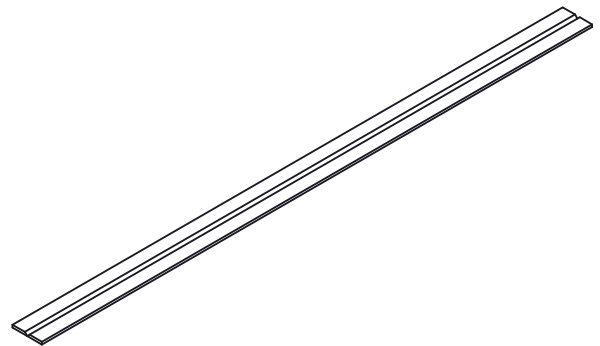

STICK - TRIM

**STEP 5**

CUT STICK TO FIT FROM CEILING TO EDGE OF WINDOW/DOOR (DIMENSION A) SHOWN BELOW

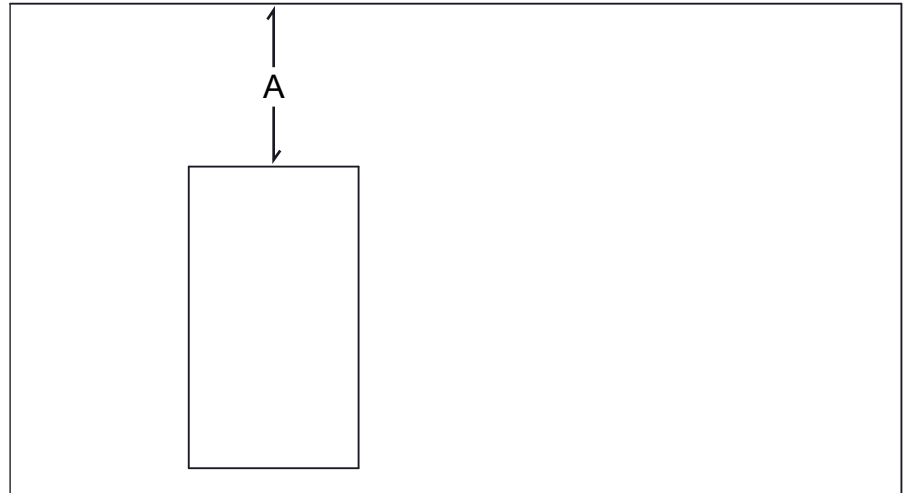

CUT TRIMS TO FIT FROM CEILING TO EDGE OF WINDOW/DOOR (DIMENSION B) SHOWN BELOW

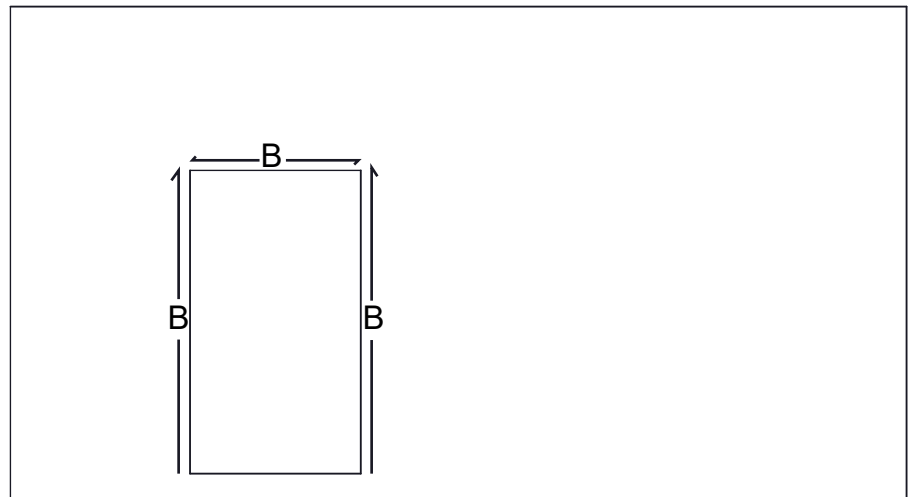

**STEP 6**

USE THE DROP SAW TO CUT ZINTRA STICKS  
AND STICKS TRIM TO DIMENSIONS MEASURED  
IN STEP 6

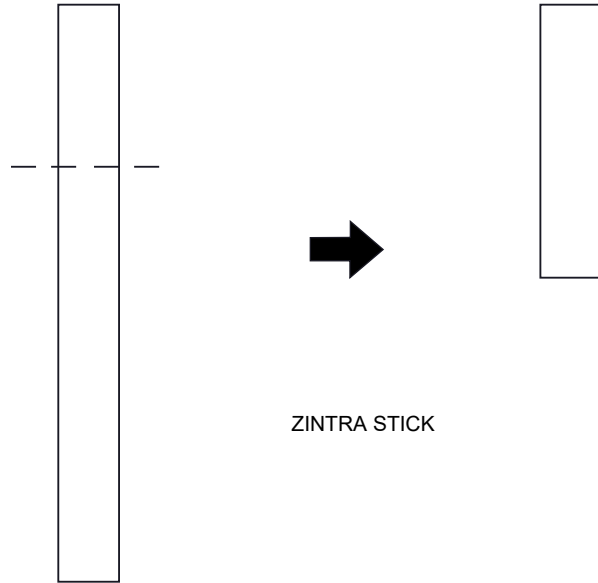

CUT STICKS TRIM AT 45 DEGREE ANGLES

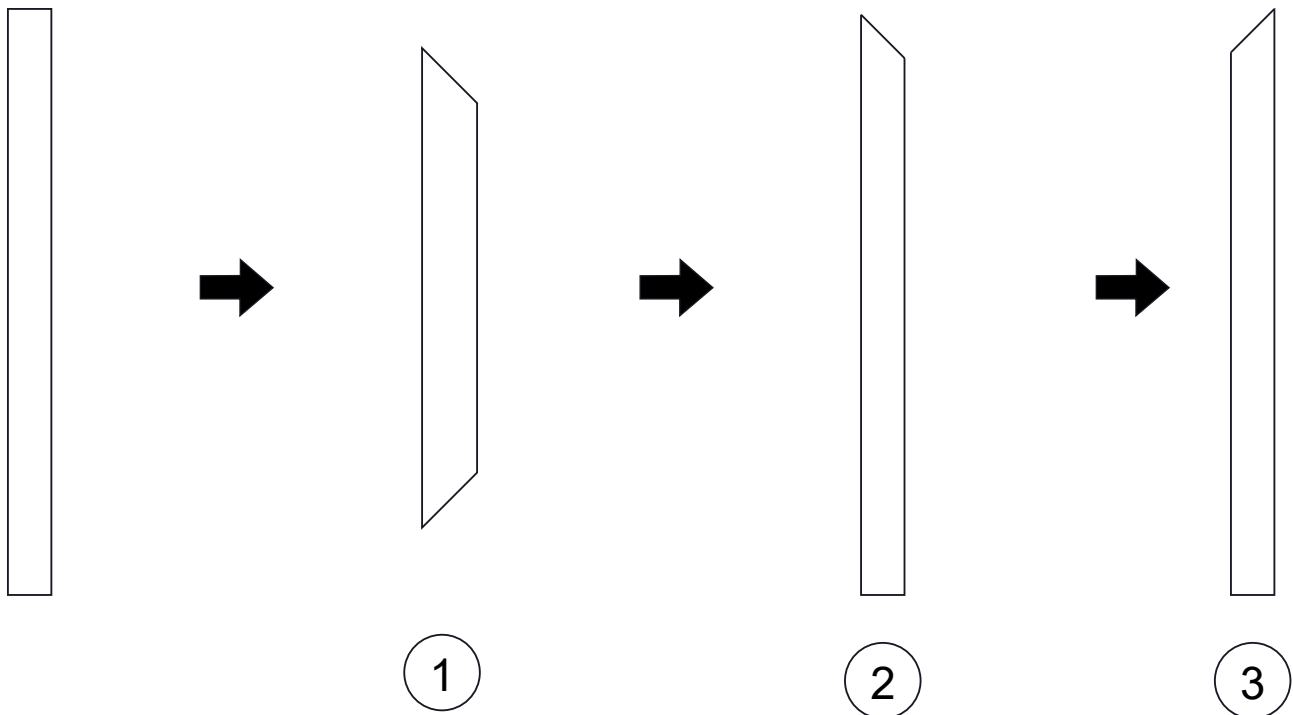

**STICKS TRIM VARIATIONS**

**STEP 7**

INSERT ZINTRA STICKS INTO  
ALUMINIUM NOTCHES AS SHOWN

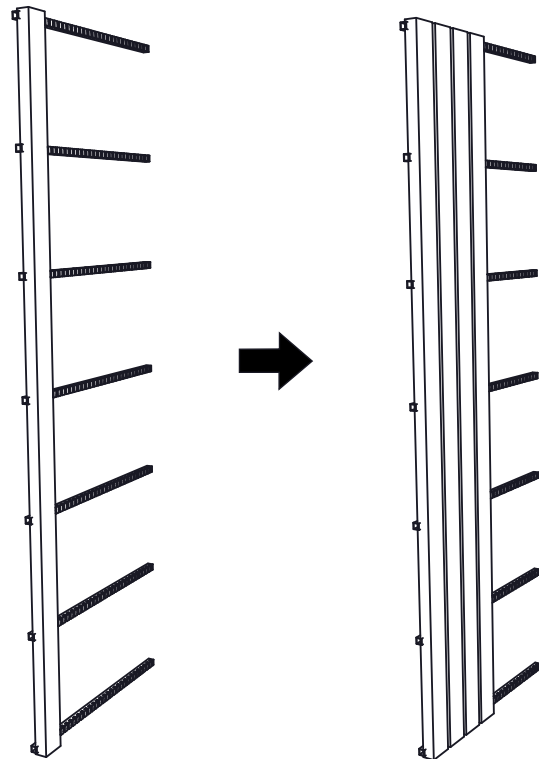
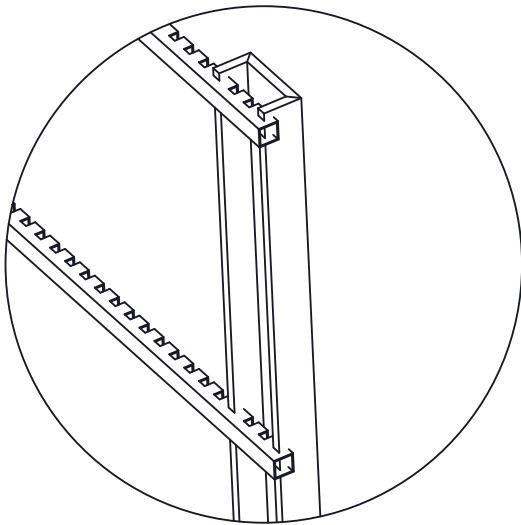
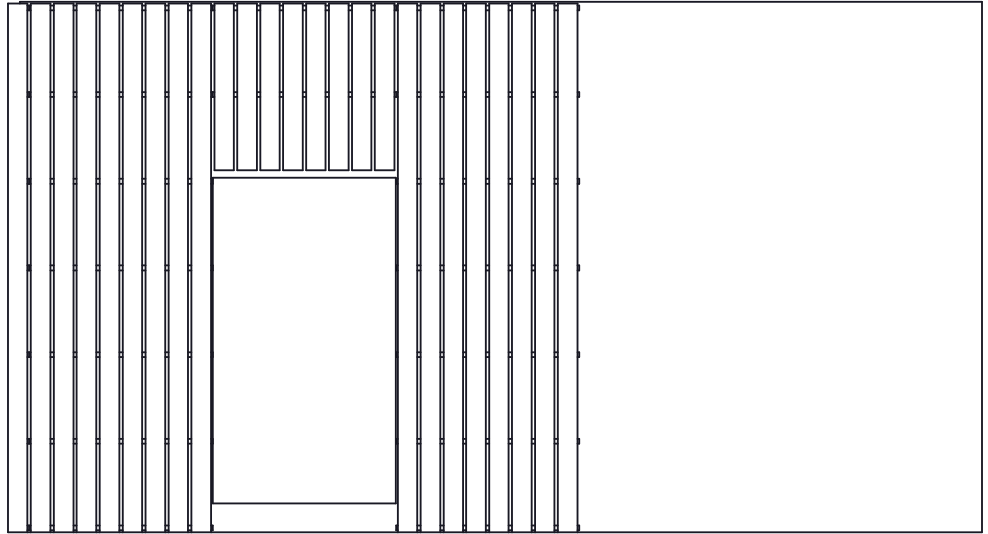



**STEP 8**

DRY FIT STICKS TRIM TO ENSURE  
A GOOD FIT

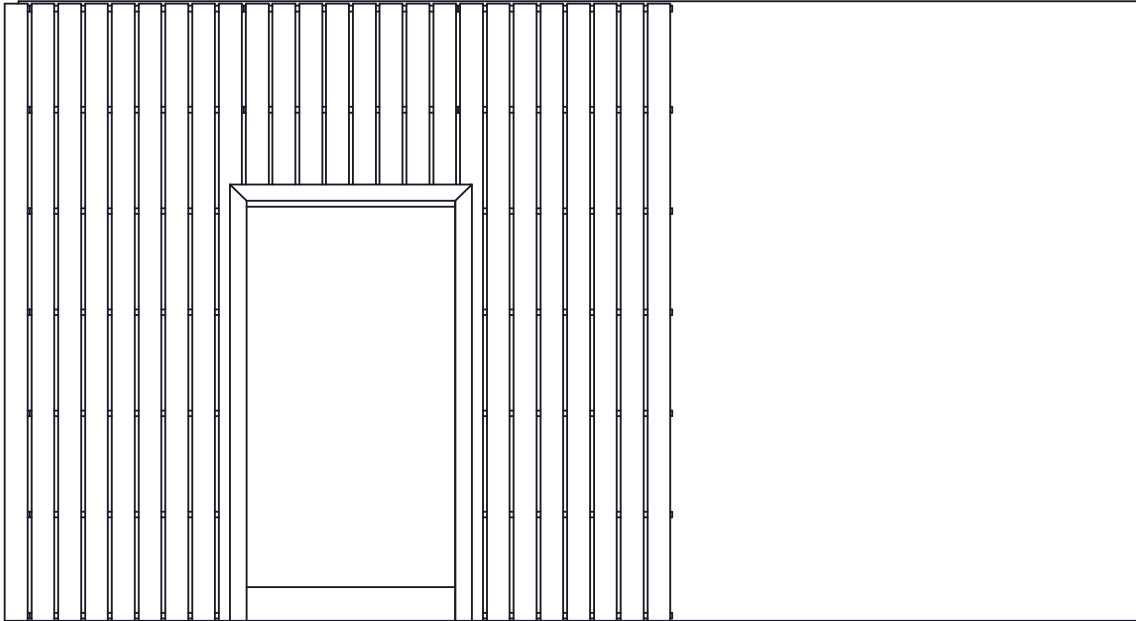

**STEP 9**

APPLY CONSTRUCTION ADHESIVE TO INSIDE OF  
STICKS TRIM. THEN STICK TO ZINTRA STICKS  
THAT ARE ALREADY INSTALLED

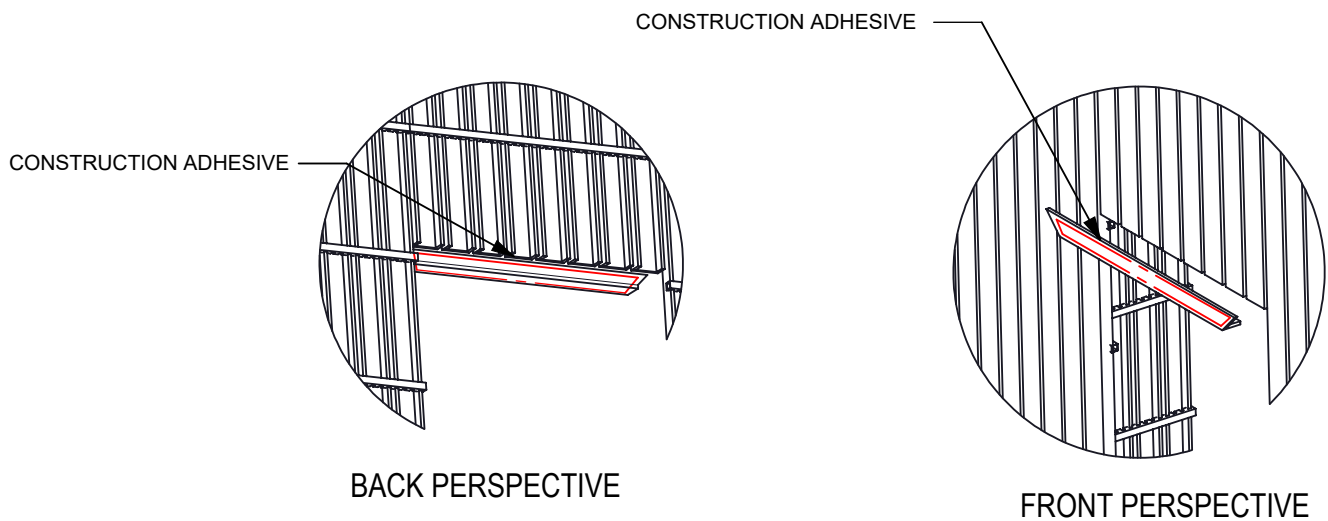

**FINISHED INSTALL**

